

# THE GUS FISHER GALLERY

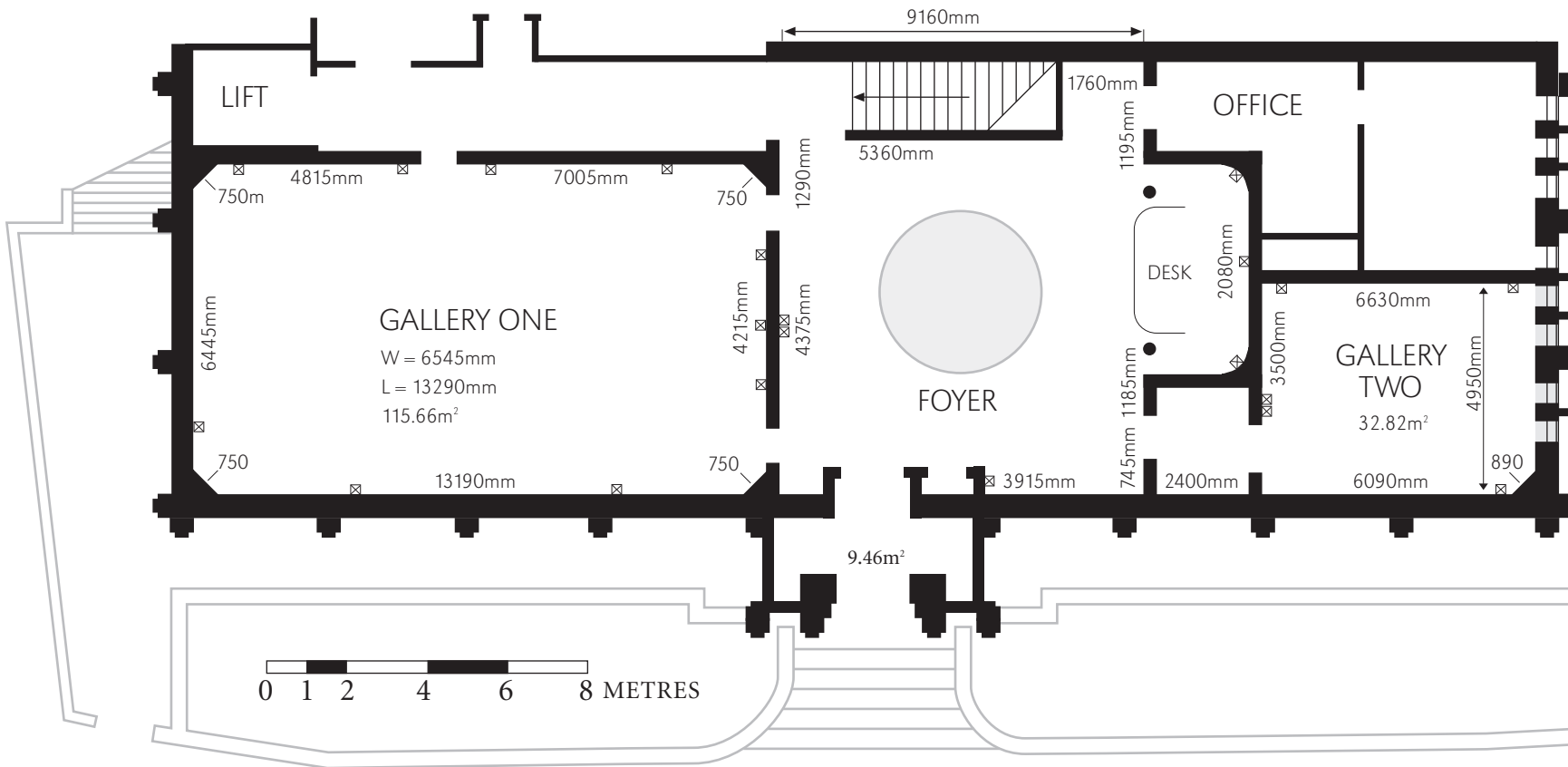

## NOTES

### Floor

Terrazzo tiles  
Floor load capacity: 5.0 PA

### Walls

Gib plasterboard  
Each wall has a 0.215m high skirting board  
Lineal Metres 70.020

### Wall heights

Gallery One: 3990mm  
Gallery Two: 4150mm  
Gallery Lobby: 3950mm  
Above balustrade: 3000mm  
Staff desk area: 3250mm

### Doors

Front door: 1400 x 2600mm  
Glass doors: 1500 x 2260mm  
Interior doors: heritage inlaid wood  
Gallery One: largest doorway 840 x 2090mm  
Gallery Two: smallest doorway 850 x 2090mm

### Lighting

Gallery One and Two: dimmable  
linear halogen and fluorescent 50 watt

○ = UV treated historic glass dome

⊠ = power point

## THE GUS FISHER GALLERY

Tuesday – Friday 10am – 5pm  
Saturday 12 – 4pm

The Kenneth Myers Centre  
74 Shortland Street  
Auckland, New Zealand

Telephone 64 9 923 6646  
[www.gusfishergallery.auckland.ac.nz](http://www.gusfishergallery.auckland.ac.nz)  
[gusfishergallery@auckland.ac.nz](mailto:gusfishergallery@auckland.ac.nz)

